

尺寸图 Dimensional drawing

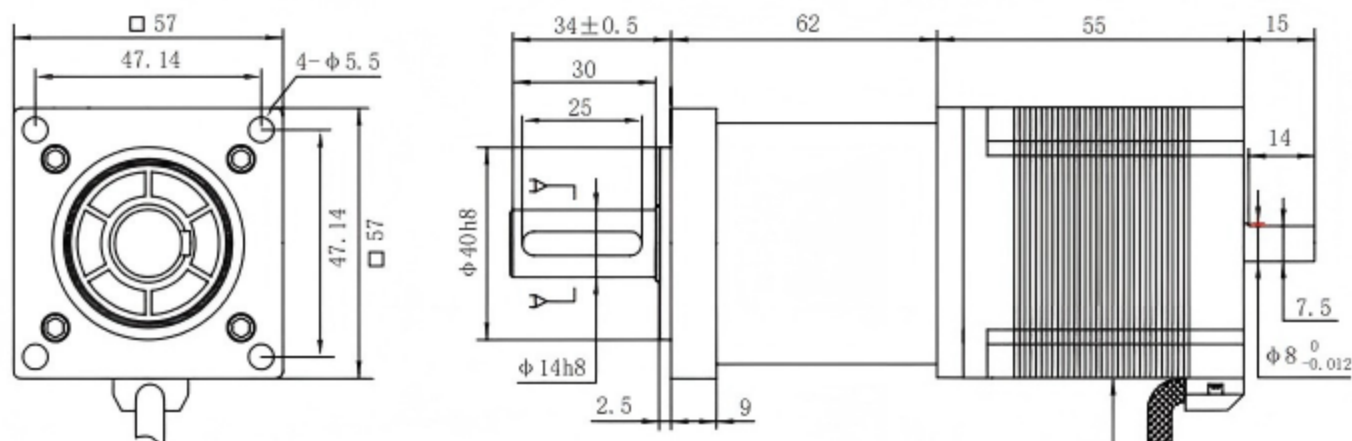

绕线图 Wiring Diagram

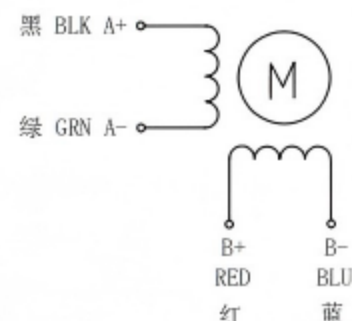

Excitation sequence and direction of clockwise

STEP	A+	B+	A-	B-
1	+	+	-	-
2	-	+	+	-
3	-	-	+	+
4	+	-	-	+

seen from the mounting surface it is clockwise

1.步距角 Step angle	1.8° ±5%
2.相数 Number of phase	2
3.相电压 Phase voltage	2.52 VDC
4.相电流 Phase current	2.8 Amp
5.相电阻 Phase resistance	0.9 Ω ±10% (At 20° C)
6.相电感 Phase inductance	2.5 mH ±20%
7.静力矩 Static moment	1.26 N.m
8.绝缘等级 Insulation class	Class B
9.绝缘电阻 Insulation resistance	100MΩ min. (500V DC)
10.环境温度 Ambient temperature	-20° ~+50°
11.环境湿度 Ambient hum	15% to 95%
12.电机重量 Motor weight	Approx 0.6 Kg
13.使用电压 Use voltage	VDC:20-48V VAC24-36V
14.推荐驱动器 Recommended drive	OK2D656T OR OK2D872

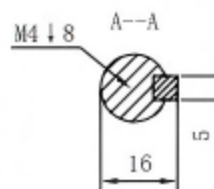

减速机级数 Reducer series	Level 1				Level 2							
减速比 Exact reduction ratio	3	4	5	10	15	20	25	30	36	40	50	100
额定负载 Rated load (N.m)	30	24	30	20	30	24	30	28	25	25	25	20
减速机长度 (L-mm)	53				70							
效率 Efficiency %	96				92							
回差 Arcmin (arcmin)	≤15				≤25							
噪音 (DB) Noise	≤58				≤55							
减速机重量 Reducer weight	0.7				0.95							

工艺 Technology	单位 Unit	mm
设计 Design		
审核 Chck		
批准 Approved	Eric Z	比列 Scale 1: 1

DRAWING

OK57DL56-284B-HG50

Shenzhen Sunshine Sea Technology Co., Ltd