

尺寸图 Dimensional drawing

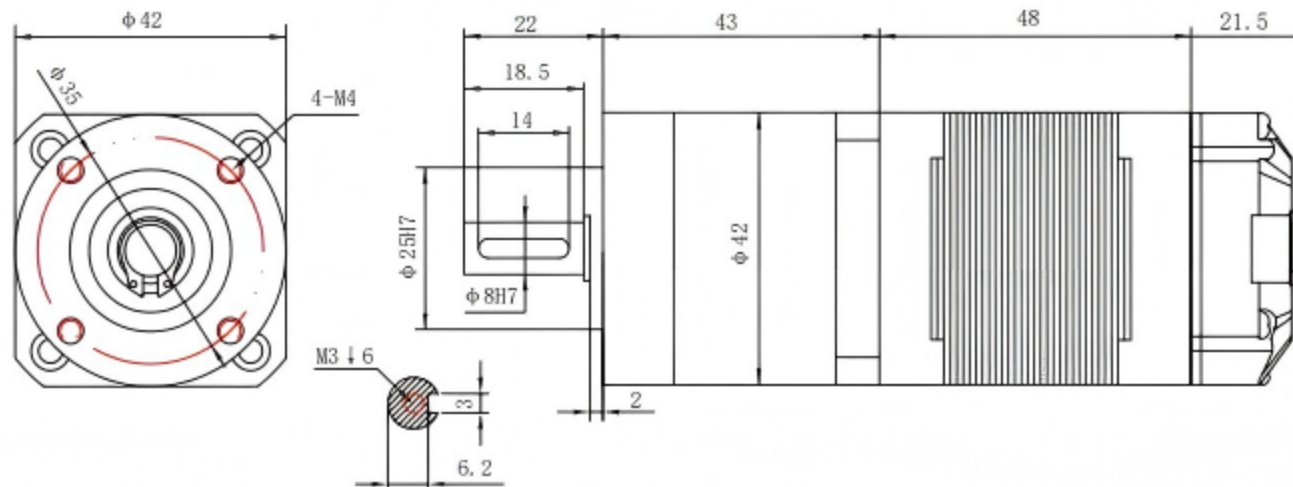

绕线图 Wiring Diagram

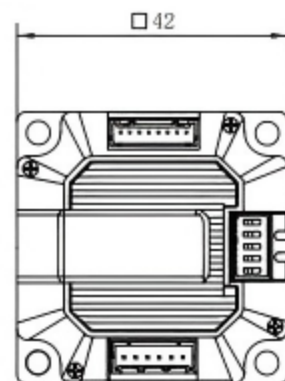

| | |
|------------------------------|-----------------------|
| 1.步距角 Step angle | 1.8° ±5% |
| 2.相数 Number of phase | 2 |
| 3.相电压 Phase voltage | 2.8 VDC |
| 4.相电流 Phase current | 2.0 Amp |
| 5.相电阻 Phase resistance | 1.4 Ω ±10% (At 20° C) |
| 6.相电感 Phase inductance | 3.0 mH ±20% |
| 7.静力矩 Static moment | 0.43 N.m |
| 8.绝缘等级 Insulation class | Class B |
| 9.绝缘电阻 Insulation resistance | 100M Ω min. (500V DC) |
| 10.环境温度 Ambient temperature | -20° → +50° |
| 11.环境湿度 Ambient hum | 15% to 95% |
| 12.电机重量 Motor weight | Approx 0.4 Kg |
| 13.使用电压 Use voltage | VDC:24-36V |
| 14.推荐驱动器 Recommended drive | OK2D4020A |

| 减速机级数 Reducer series | Level 1 | | | | Level 2 | | | | | | | |
|---------------------------|---------|---|----|----|---------|----|----|----|----|----|----|-----|
| 减速比 Exact reduction ratio | 3 | 4 | 5 | 10 | 15 | 16 | 20 | 25 | 30 | 40 | 50 | 100 |
| 额定负载 Rated load (N.m) | 10 | 9 | 10 | 6 | 10 | 9 | 9 | 9 | 9 | 8 | 7 | 6 |
| 减速机长度 (L-mm) | 43 | | | | 53.5 | | | | | | | |
| 效率 Efficiency % | 95 | | | | 90 | | | | | | | |
| 回差 Arcmin (arcmin) | ≤15 | | | | ≤25 | | | | | | | |
| 噪音 (DB) Noise | ≤58 | | | | ≤55 | | | | | | | |
| 减速机重量 Reducer weight | 0.25 | | | | 0.3 | | | | | | | |

| | | | | | |
|---------------|---------|----------|------|---------|---------------|
| 工艺 Technology | | 单位 Unit | mm | DRAWING | 42EC48-YT-HG5 |
| 设计 Design | | | | | |
| 审核 Chcek | | | | | |
| 批准 Approved | Betty Y | 比列 Scale | 1: 1 | | |